

\G1033\G1033\b\Calculations for Gwinnett County Tree Ordinance

10.77 Acreage

10.77 ac

0 Less the Buffers

= 10.77 ac

SDF = 16 X Acreage

= 172.32 TDU

EDF = 79.23 Tree Save Areas

= 79.23 Units

RDF = 122.80 Units for Planted Trees

= 122.80

SDF = RDF + EDF = -29.71 TDU

There is a surplus of 29.71 TDU. Therefore the TDU requirements for this project have been met. There are no buffers; therefore all the trees planted and saved are outside of any buffers.

Area	Acres	Basal Area (10 factor prism)	Units
1	0.45	112.5	50.63
2	0.11	260	28.60
<b>Total</b>			<b>79.23</b>

QTY.	Common/Botanical Name	Size
5	Southern sugar maple (Acer brabatum)	3"
5	<b>Total</b>	

Parking lot requirements, require 1 tree per 7 parking spaces. There 17 parking spaces and 5 trees have been provided.

QTY.	Common/Botanical Name	Size	Spacing	Units	% Units	Units/Species
10	White oak (Quercus alba)	2"	20' o.c. min.	0.5	4.07	5.00
24	Flowering dogwood (Coruns florida)	2"	12' o.c. min.	0.6	11.73	14.40
59	Green Giant (Thuja plicata)	2", min. 8'	10' o.c. min.	0.5	24.02	29.50
32	Leyland Cypress (Cupressocyparis leyland)	2", min. 8'	15' o.c. min.	0.5	13.03	16.00
57	Cryptomeria (Cryptomeria japonica)	2", min. 8'	10' o.c. min.	0.5	23.21	28.50
19	Red maple 'October Glory' (Acer rubrum)	3"	20' o.c. min.	0.6	9.28	11.40
9	Redbud 'Forest Pansy' (Cercis canadensis)	2"	10' o.c. min.	0.5	3.66	4.50
27	Southern magnolia 'Little Gem' (Magnolia grandiflora)	2", min. 8'	10' o.c. min.	0.5	10.99	13.50
<b>237</b>	<b>Total</b>				<b>100.00</b>	<b>122.80</b>



5074 BRISTOL INDUSTRIAL WAY  
SUITE A  
BUFORD, GEORGIA 30518  
(770) 271-2868

PREPARED FOR:  
**PRECISION DESIGN AND DEVELOPMENT, INC.**  
6650 SUGARLOAF PKWY.  
SUITE 200  
DULUTH, GA 30097  
MR. BO BROOKS  
(770) 932-1332

PROJECT NAME:  
**BERKELEY CHASE**

TASK:

LANDSCAPE PLAN



PROJECT INFORMATION:

**BERKELEY CHASE**  
Project Name  
06-067  
Project Number  
SOUTH OLD PEACHTREE ROAD  
Project Address  
270 & 278  
Land Lot No.(s)  
6th  
District  
GWINNETT COUNTY, GEORGIA  
County, State

DATE	REVISION
	1
	2
	3
	4
	5
	6
	7
	8
	9

NO.	DESIGN	SCALE
1	TVM DESIGN	AS SHOWN SCALE
2	TVM DRAWN	11 of 20
3	TVM CHECKED	SHEET
4	DATE	PROJECT NO.

Hole should be 2 - 2 1/2 times as wide as root ball

Place root ball on compacted pedestal

Back fill with excavated soil only amend when necessary

Lightly compact soil around bottom 2/3 of root ball

Mulch 2 - 4 inches deep

Stake tree only when necessary, and then loosely to allow movement of trunk in the wind.

Burlap and wire basket should be removed from the top 1/3 of root ball MINIMUM

Top of root ball should be same level as existing soil

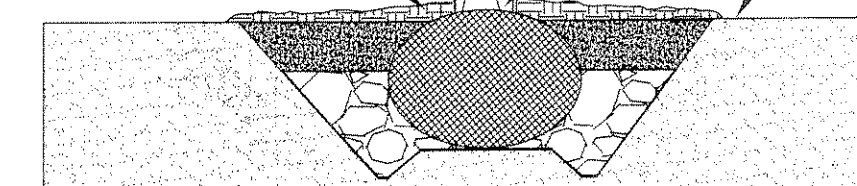

**GWINNETT COUNTY NOTES**  
1. BUFFERS AND TREE SAVE AREAS ARE TO BE CLEARLY IDENTIFIED WITH PROTECTIVE FENCING PRIOR TO COMMENCEMENT OF ANY LAND DISTURBANCE.  
2. DECIDUOUS TREES SHALL BE AT LEAST 2" IN DIAMETER AND EVERGREEN TREES SHALL BE AT LEAST 4 FEET IN HEIGHT AT TIME OF PLANTING.

**TREE REPLACEMENT NOTES:**  
REPLACEMENT PLAN MUST BE VERIFIED PRIOR TO THE ISSUANCE OF THE CERTIFICATE OF OCCUPANCY OR ACCEPTANCE OF THE PROJECT. CALL THE DEPARTMENT OF PLANNING AND DEVELOPMENT FOR AN INSPECTION. ALL PLANT MATERIALS ARE TO CONFORM TO THE AMERICAN STANDARD FOR NURSERY STOCK 1990 EDITION AMERICAN ASSOCIATION OF NURSERYMEN.  
\*ALL TREES WILL BE WATERED OR IRRIGATED UNTIL ESTABLISHED.  
Trees selected for planting must be free from injury, pests, disease, nutritional disorders or root defects, and must be of good vigor, so as to assure a reasonable expectation of survivability.

10' PHONE LIN. (PER RECIPROCA AGREEMENT DB, PG. 187)

N/F  
CITY LIGHTS, L.L.C.  
DB. 43625 / PG. 164  
ZONED C-2  
6-270-082

There is a 50' landscape strip along South Old Peachtree Road. 5 trees and 5 shrubs are required per every 25'. 627.78' divided by 25 equals 25.11 times 5 equals 125.56. 126 trees have been provided in the landscape strip and 126 shrubs have been provided.

QTY.	Common/Botanical Name	Size	Spacing
14	Ornamental grass (Miscanthus x)	5 gal.	48" o.c.
28	Native azalea (Rhododendron flammem)	3 gal.	42" o.c.
55	Ruby loropetalum (Loropetalum chinese 'Ruby')	3 gal.	42" o.c.
6	Nelli R. Stephens (Ilex x 'Nellie R. Stephens')	8' - 9' ht.	36" o.c.
22	Klein's hardy gardenia (Gardenia jasminoides)	3 gal.	36" o.c.
10	Wax myrtle (Myrica cerifera)	6' ht.	36" o.c.
<b>135</b>			

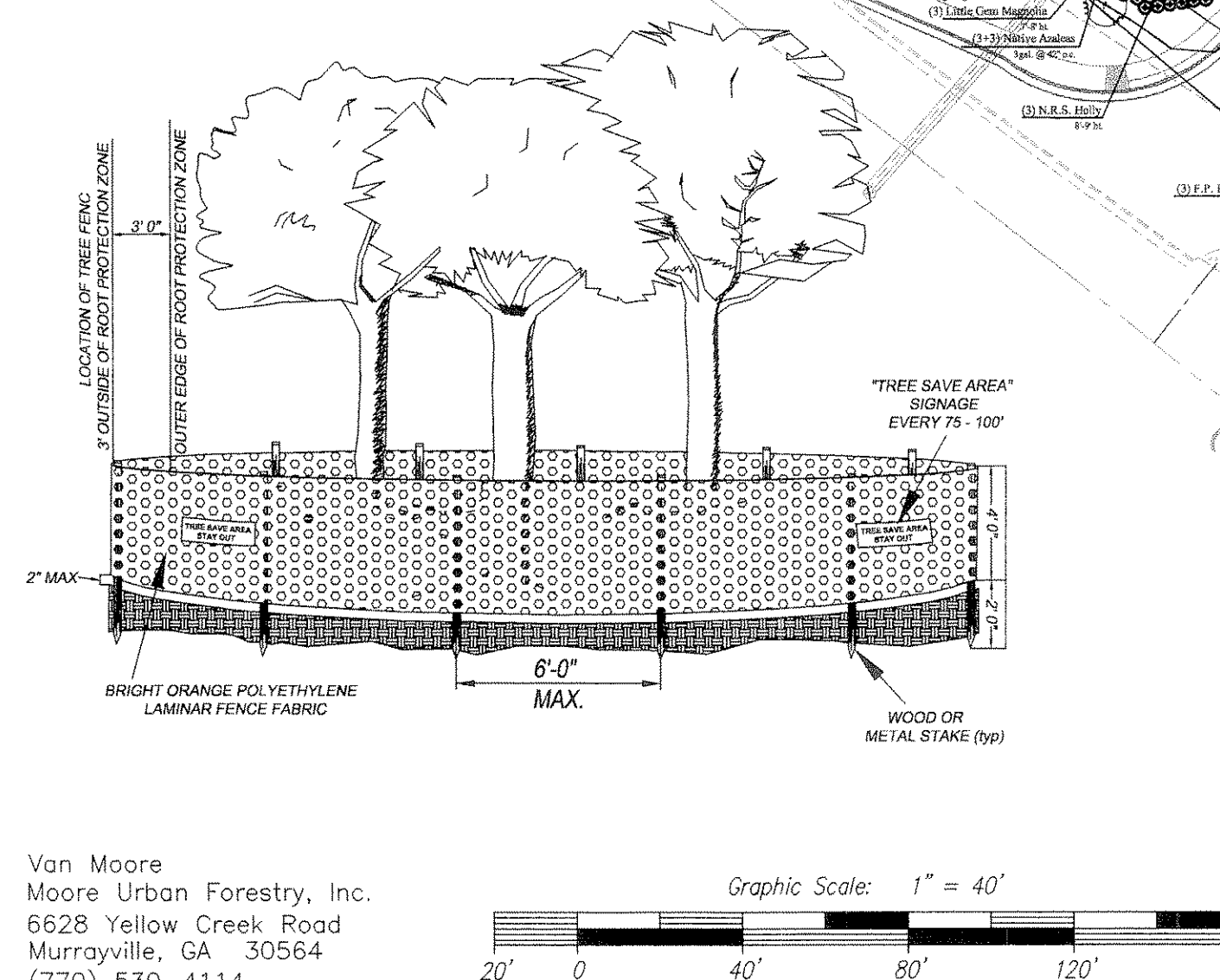
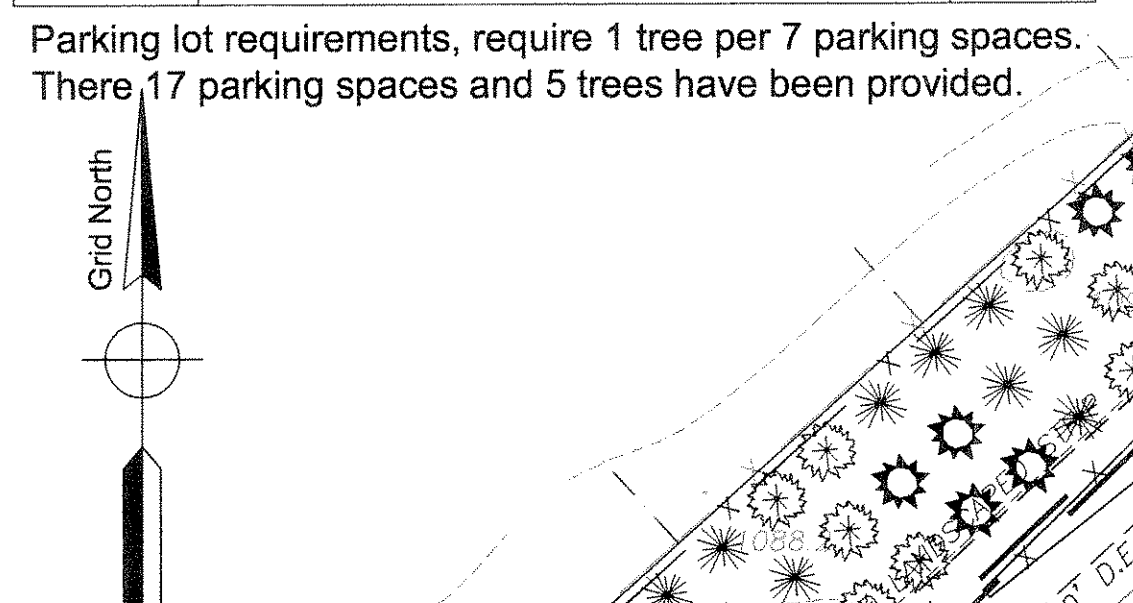

Van Moore  
Moore Urban Forestry, Inc.  
6828 Yellow Creek Road  
Murrayville, GA 30564  
(770) 530-4114

Graphic Scale: 1" = 40'  
0 20 40 80 120 160